



FORTUNE & COATES

The People's Estate Agent

<https://www.fortuneandcoates.co.uk>



20 Home Close, Harlow, CM20 3PD

Guide price £550,000

Guide Price- £550,000 - £600,000

Fortune & Coates are delighted to welcome to the market this four-bedroom semi-detached family home, situated in the sought-after location of Home Close, Harlow.

Upon entering, you are welcomed into a bright and spacious entrance hallway with stairs rising to the first floor, useful under stairs storage and access to all rooms. To the front of the property is a separate dining room, providing an ideal space for family meals or entertaining, while an additional reception room offers flexibility as a fourth bedroom, home office or playroom. A practical utility room and convenient ground floor shower room complete this level adding to the practicality of this home.

The true heart of the home is the impressive open-plan kitchen, dining and living space. The contemporary kitchen is fitted with sleek white wall and base units,

Kitchen/diner 19'10" x 19'10" (6.05 x 6.05)

Dining room 11'5" x 13'8" (3.49 x 4.18)

Utility 8'4" x 9'4" (2.55 x 2.86)

Bedroom 8'4" x 13'8" (2.55 x 4.18)

Bedroom 11'4" x 13'8" (3.46 x 4.18)

Bedroom 11'4" x 9'9" (3.46 x 2.99)

Bedroom 8'0" x 8'2" (2.46 x 2.51)

Loft 19'10" x 11'3" (6.06 x 3.44)

Outbuilding 23'2" x 15'0" (7.07 x 4.58)

AGENT NOTE: The information provided about this property does not constitute or form part of an offer or contract, nor may it be regarded as representations. All interested parties must verify accuracy and your solicitor must verify tenure/lease information, fixtures & fittings and, where the property has been extended/converted, planning/building regulation consents. All dimensions are approximate and quoted for guidance only as are floor plans which are not to scale, and their accuracy cannot be confirmed. Reference to appliances and/or services does not imply that they are necessarily in working order or fit for the purpose.

Floor Plan

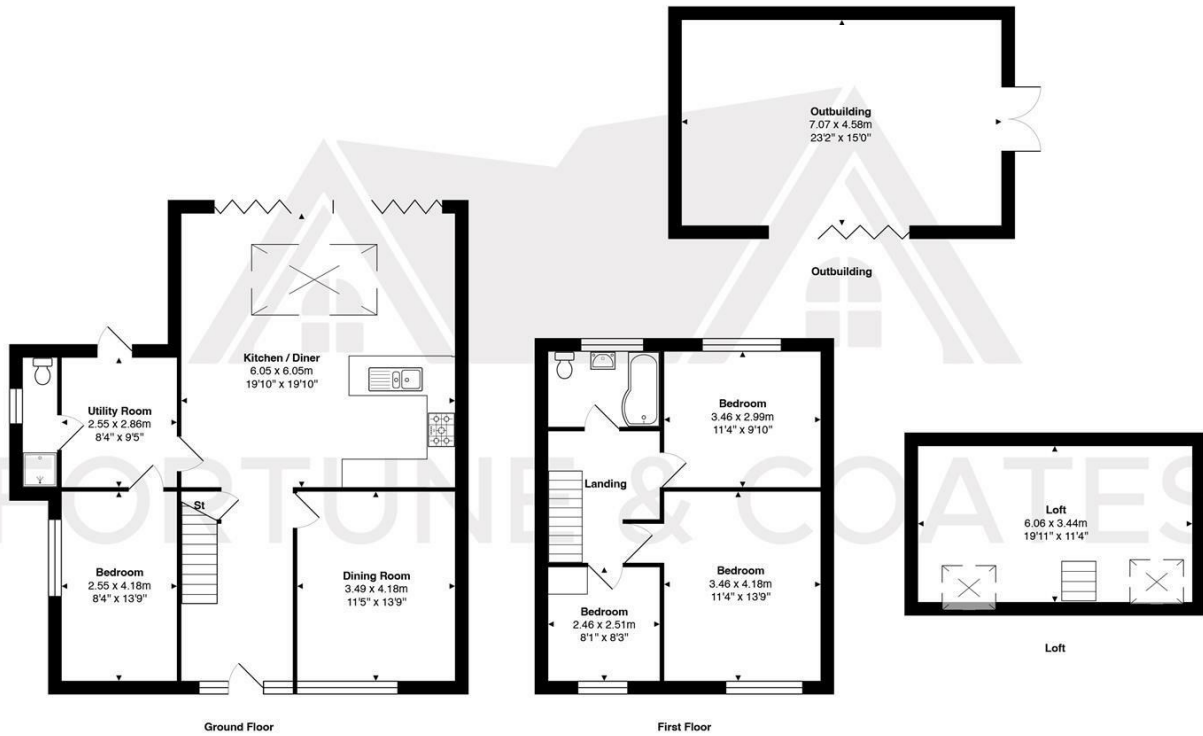

Total Area: approx. 180.9 m² ... 1947 ft²

THE FLOORPLAN IS FOR ILLUSTRATIVE PURPOSES ONLY AND IS NOT TO SCALE. Measurements and features are approximate and may differ from the actual property. Verify all details independently; no liability is accepted for errors or omissions.

Property marketing provided by www.fotomarketing.co.uk

Area Map

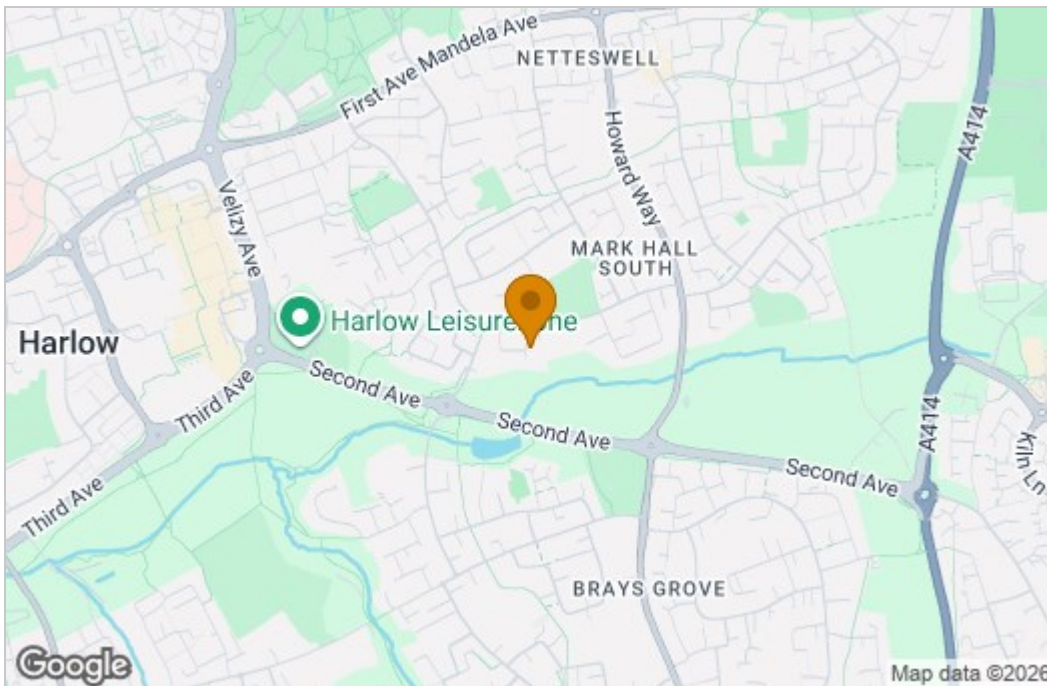

Energy Efficiency Graph

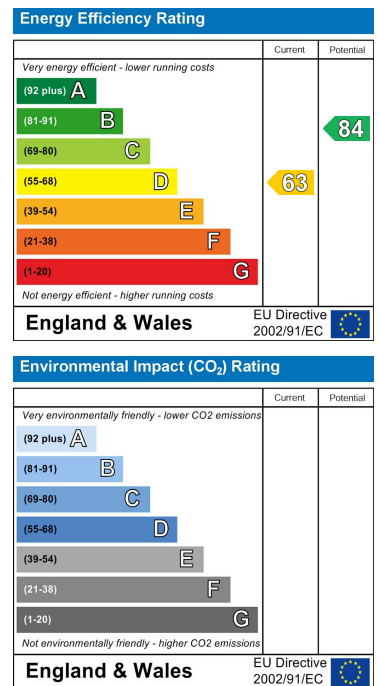

These particulars, whilst believed to be accurate are set out as a general outline only for guidance and do not constitute any part of an offer or contract. Intending purchasers should not rely on them as statements of representation of fact, but must satisfy themselves by inspection or otherwise as to their accuracy. No person in this firm's employment has the authority to make or give any representation or warranty in respect of the property.